



FACULTY AND STAFF DIRECTORY

Fond du Lac Tribal & Community College Board of Directors

Steve Couture
 Kevin Dupuis
 Stephanie Hammitt, Chair
 Robert Peacock
 Patty Petite
 Vern Zacher

Minnesota State Colleges and Universities Board of Trustees

Will Antell, Liaison to FDLTCC
 Andrew Boss
 Mary Choate
 Daniel G. Coborn
 Tyler Despina
 Cheryl Dickson
 Ivan Dusek
 Clarence Hightower
 Robert H. Hoffman, Vice Chair
 Vincent Ijioma
 Jim Louma, Chair
 Lew Moran
 David Paskach
 Ann Curme Shaw, Treasurer
 Shaun Williams

Fond du Lac Tribal & Community College Foundation Board of Directors

Debbie Briggs
 Darrell Danielson
 Marilyn Grover
 John McKinney
 Joan Nurminen
 Randy Wagner
 Chuck Walt
 Dale Wolf

Fond du Lac Tribal & Community College Administration

Day, Donald R.
 President
 Ed.D., University of North Dakota
 M.Ed., University of Minnesota-Duluth
 B.A., Bemidji State University

Anderson, Larry
 Vice President of Administration and Student Affairs
 M.S., University of Wisconsin-Superior
 B.S., University of Wisconsin-Superior

Gutting, Sister Therese
 Vice President of Academic Affairs
 Ed.D., Kennedy Western University
 M.S., University of Minnesota-Duluth
 B.S., Viterbo College

Skurich, Elliot
 Director of Fiscal Operations
 B.B.A., University of Minnesota-Duluth

Fond du Lac Tribal & Community College Faculty

*Faculty at outreach sites

Ahlgren, Marla
 English
 M.A., University of Minnesota-Duluth
 B.S., University of Minnesota-Duluth

Anderson, Michael
 Law Enforcement
 B.A., University of Minnesota-Duluth

Autumn, Stephanie*
 American Indian Studies

Beaudreau-Patton, Elaine*
 English
 M.S., University of Wyoming
 B.A., College of St. Scholastica

Beckman, Brad
 Physical Education
 B.S., University of Wisconsin-Superior

Blascyk, Theresa
 Biology
 B.A., Concordia College

Braxton-Brown, Jonah
History/Political Science
M.A. Candidate, Washington State University
M.A., Eastern Washington University
B.A., University of Redlands

Briggs, Sara Marie
Speech
B.S., Moorhead State

Broughton, Nancy
Library/Archives Director
M.A., University of Wisconsin-Madison
M.S., University of Nevada-Reno
B.S., University of Wisconsin-Platteville

Bruning, Marcus
Health/Law Enforcement
B.A., Concordia College
Law Enforcement, Normandale Community
College

Chaplin, William*
Computer Science/Business
B.S., University of Wisconsin

Dillon, Edward*
Math
M.S., University of Iowa
B.S., University of Iowa

Diver, Charlin F.
English
M.Ed., Harvard University
B.A., University of Minnesota-Duluth

Downwind, Bradley*
Anishinaabe Language

Drewlo, G. Scott
Corrections
B.S., St. Cloud State University

Estey, Denise*
Psychology
M.S., University of Wisconsin-Superior
B.S., Bemidji State University

Fellegly, Anna
English
Ph.D., University of Minnesota
M.A., English, University of Minnesota
B.S., English, University of Wisconsin-Superior

Foster, Scherrie
Speech/Theatre
M.A., University of Minnesota
B.S., University of Minnesota
B.A., St. Mary's College

Gile-Aubid, Candi
American Indian Studies/Anthropology
M.S., University of Minnesota-Duluth
B.S., St. Cloud State University

Gillespie, Michael
Biology
M.S., University of Minnesota-Duluth
B.A., University of Minnesota-Duluth

Gittings, Ronald
Sociology
M.S., Indiana State University
B.A., Marian College

Grace, Patricia
Counselor
M.S., Drake University
B.S., Mankato State University

Graham, Cheryl
Anthropology
M.S., West Virginia University
B.S., Northern Michigan University

Greeman, David
Law Enforcement
M.S., University of Wisconsin-Superior
B.A., College of St. Thomas
A.A., Normandale Community College

Gustafson, John
Computer Science/Electric Utility Technology
M.S., University of Minnesota
Bachelor of Physics, University of Minnesota

Hanson, Anita
Counselor/Office for Students with Disabilities
M.A., University of Minnesota-Duluth
B.S., North Dakota State University

Hanson, Donald
Chemistry
M.S., University of Wisconsin-Superior
B.S., University of Minnesota-Duluth

Hedberg, Kathleen
Child Development
M.Ed., University of Minnesota-Duluth
B.S., University of Minnesota-Duluth

- Holmes, Cynthia
Art
M.A.E., Rhode Island School of Design
B.F.A., Minneapolis School of Art and Design
- Jaakola, Elizabeth
Music/American Indian Studies
B.M., University of Minnesota-Duluth
- Jarvinen, Donald
Human Services
M.S., University of Wisconsin-Superior
B.A., St. John's University
- Jones, Dan
Anishinaabe Language
B.S., Bemidji State University
A.A., Rainy River Community College
- Kallis, Bill
Counselor/Psychology
M.A., University of North Dakota
B.A., Minot State University
- Karnes, Katrina
Spanish
M.S., University of Wisconsin
B.A., University of Wisconsin
- Kennedy, Jason
Geography/Business
M.S., Minnesota State University-Mankato
B.A., California State University-Sacramento
- Kleinke, Kristin
Music/Philosophy
M.M., University of Minnesota
M.A., Northwestern Lutheran Theological
Seminary
B.A., Gustavus Adolphus College
- Lamirande, Wade
Law Enforcement
B.A., University of Minnesota-Duluth
- Langhorst, Glenn
Geology/Physics
M.Ed., University of Minnesota-Duluth
B.A.S., University of Minnesota-Duluth
- Lee, Annette
Math/Physics
M.F.A., Yale University
B.A., University of California-Berkeley
B.F.A., University of Illinois-Urbana Champaign
- Lemon, Charles
Law Enforcement
A.A., Hibbing Community College
- Luoma, Milton
eCrime/Computer Science
J.D., William Mitchell College of Law
M.S., University of Minnesota-Duluth
M.S., University of Dayton
M.B.A., University of Dayton
B.S., Case Western Reserve University
- Lyons, Scott
Law Enforcement
B.A., University of Minnesota-Duluth
- Maciewski, Bryan Jon
Business/Marketing
M.B.A., Embry Riddle Aeronautical University
B.S., University of Maryland
A.A., St. Leo College
A.S., Community College of Air Force
- Magaard, Diana
Law Enforcement
B.A., Mankato State
- Martineau, Roxanne
Speech/Anthropology
M.S. Candidate, University of Minnesota
B.S., University of Minnesota
A.A., Fond du Lac Tribal & Community College
- Means, William*
Anthropology
- Monson, Mary
Nursing
B.A., College of St. Scholastica
A.A., Normandale Community College
- Jean Ness*
Psychology
Ed.D, University of Minnesota
M.A. University of St. Thomas
B.S., University of Minnesota
- Nicholson, Stuart*
Physics
Post Doc., State University of New York-Albany
Ph.D., University of Georgia
M.S., State University of New York-Albany
B.S., State University of New York-Albany

Novack, Yvonne*
American Indian Studies
B.A., University of California-Berkeley

Olsen, Mark*
Physical Education
B.S., North Dakota State University

Pertler, Thomas
Law Enforcement
J.D., Hamline University
B.A., University of Minnesota-Duluth

Preston, Margaret*
English
M.A., New Mexico State University
B.A., University of Minnesota

Pucel, Mary Gayle
Business/Political Science
M.B.A., St. Cloud State University
M.S., St. Cloud State University
B.S., St. Cloud State University

Shene, Robert
Law Enforcement
B.S., United States Coast Guard Academy

Shultz, Judith
Reading/Coordinator of Center for Academic
Achievement
M.A., University of Northern Iowa
B.A., University of Northern Iowa
A.A., Marshalltown Community College

Smith, Shannon*
Human Services
B.A., St. Mary's, University of Minnesota

Stead, Arnold*
English/Philosophy
Ph.D., University of Missouri-Columbia
M.A., Iowa State University
B.A., Bemidji State

Straub, Wayne
Physical Education

Tibbetts, Robert
Anishinaabe Language

Trebian, Mark
Computer Science
M.S., University of Wisconsin-Stout
B.S., University of Wisconsin-Platteville
B.S., Mount Senario College

Waller, Roger
Law Enforcement
B.A., University of Minnesota-Duluth

Walton, Melissa
Child Development
M.S., University of Wisconsin-Superior
B.A., College of St. Scholastica

Wappes, Connie
Mathematics
M.Ed. Candidate, St. Mary's University
B.S., Ohio State University

Wiesen, Donald
Business
B.A., University of Minnesota-Duluth

Wendorff, Frances
Mathematics/Reading
M.A. Candidate, University of Wisconsin-Superior
B.A., College of St. Benedict

Weston, Dale*
English
B.S., Hamline University

Wetherbee, Ted
Mathematics/Computer Science
M.S., Ohio University
B.A., University of Minnesota-Duluth

Willoughby, Lynn
Human Services/Health/Sociology
M.Ed., University of Wisconsin-Superior
B.S., University of Wisconsin-Superior

Wold, Amy
Biology
M.S., University of Minnesota-Duluth
B.A., Luther College

Wold, Andrew
Biology
M.S., University of Minnesota
B.A., Luther College

Zimm, Laura
Law Enforcement
J.D., William Mitchell School of Law
B.A., University of Minnesota-Duluth

Fond du Lac Tribal & Community College Staff

Adamscheck, Dennis
Network Engineer/Webmaster
A.A., Fond du Lac Tribal & Community College

Anderson, Karene
Faculty Office Secretary
Diploma, DAVTI

Beamer, Lori
Account Clerk
B.S., St. Cloud State University

Bernhardson, Mark
Maintenance Foreman

Bergstrom, Amy
Director, American Indian Teacher Corps
Ed.M., Harvard University
B.A.A., University of Minnesota-Duluth

Bohlmann, Brad
Computer Network Specialist

Broeffle, Candi
Customized Training Representative
B.A. Candidate, Concordia University
A.A., Fond du Lac Tribal & Community College

Camp, Mashugashon
Clerical
A.A., Fond du Lac Tribal & Community College

Carlson, Bruce
Director, Housing
B.S., University of Wisconsin-Superior
A.A., Fond du Lac Tribal & Community College

Clark, Brian
Maintenance

Cresap, Robert
Director, Visions 2000 Program
M.S., University of South Dakota
B.S., Valley City State

DeFoe, Shirley
Director, International Program

Denny, Janice
Director, Urban Outreach Program
B.S., Metropolitan State University
A.A.S., Minneapolis Community College

Eisfeld, Bonnie
College Bookstore Coordinator
A.A., Fond du Lac Tribal & Community College

Fall, Dennis
Maintenance
A.A., Fond du Lac Tribal & Community College

Gassert, Deb
Recruiter, American Indian Teacher Corps

Gordon, Nancy
Admissions Representative
B.A., Concordia University
A.A., Rainy River Community College

Gordon, Wade
Director of Institute of Human Understanding
Ed.D. Candidate, University of Minnesota
Psy.D., Minnesota School of Professional
Psychology
B.S., University of Wisconsin-Superior
A.A., Fond du Lac Tribal & Community College

Hagenah, Paula
Business Office Clerk
A.A.S., Hibbing Community College

Hanson, Melissa
Administrative Assistant,
Institutional Advancement

Haynes, Barbara
Family Education Specialist
M.A., University of Wisconsin-Stout
B.S., University of Wisconsin-Stout

Heistand, Peggy
Director, Woodlands Wisdom Project
M.A., University of Minnesota-Duluth
B.S., University of Nebraska

Isham, Donna
Receptionist
A.A.S., Fond du Lac Tribal & Community College

Juten, Jane
Tutor/Student Support Services
B.A., St. Olaf College

Kermeen, Jeannie
Customized Training Representative

King, Margaret
Advisor/Student Support Services
B.A., College of St. Scholastica
A.A., Mesabi Range College

Kowalczak, Courtney
Coordinator, St. Louis River-River Watch Program
B.S., University of Minnesota-Duluth

Leno, Greg
Maintenance
Certificate, DAVTI

Leno, Leah
Director, College Records and Registration
M.S. Candidate, Colorado University
B.A., Concordia University
A.A., Fond du Lac Tribal & Community College

Libbon, Sarah
Tutor/Student Support Services
B.A., University of Minnesota-Morris

Lind, Louise
Personnel Aide
A.A., Lake Superior College

Newman, Dawn
Director, Institutional Advancement
M.A., Roosevelt University

Nicholson, Cassandra
Law Enforcement and Customized Training Clerk
A.A., Fond du Lac Tribal & Community College

Niemi, Jennifer
Advisor/Mentor, American Indian Teacher Corps
B.A., University of Minnesota-Duluth
A.A., Lake Superior College

Olbekson, Ernie
Maintenance

Otis, Cissy
Director, Institutional Research
Health Careers Recruiter
M.A., Concordia University
B.A., Concordia University

Peacock, Mike
Director, Reservation Programs
B.A., Bemidji State University

Rangel, Juan
Advisor, Urban Outreach Program
B.A., University of Texas

Rauschenfels, Diane
Library Technician
A.A.S., Lake Superior College

Robinson, Amy
Administrative Assistant, Records Office and
Financial Aid Office
A.A., Fond du Lac Tribal & Community College

Sandal, Jay
Director, Environmental Institute
M.S., University of Minnesota-Duluth
B.S., University of Minnesota-Duluth

Shelton, Linda
Director of Student Support Services
M.S.W. Candidate, University of Minnesota-
Duluth
B.S., College of St. Scholastica
A.A., Fond du Lac Tribal & Community College

Soyring, Mary
Executive Assistant
B.A., Concordia University

Sullivan, Rae
Accounting Technician

Sutherland, Dave
Director, Financial Aid
B.S., University of Minnesota
A.A., Lakewood Community College

Swenson, Rose
Clerical/Intermittent
A.A. Candidate, Fond du Lac Tribal &
Community College

Thomas, Gale
Clerical/Intermittent

Torgerson, Roberta
Administrative Assistant/Student Support Services
B.A., Concordia University
A.A., Fond du Lac Tribal & Community College

Urbanski, Thomas
Director, Public Information and Admissions

Wappes, Loran
Information System Engineer
B.E.E., University of Minnesota

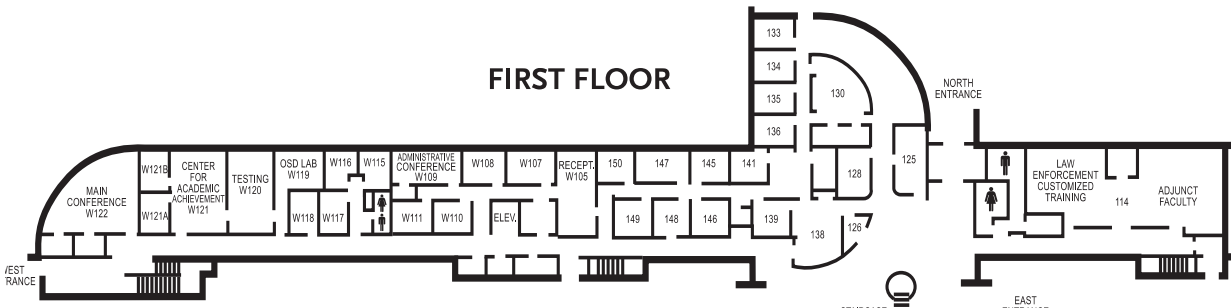

FIRST FLOOR

East Wing

- 114 Adjunct Faculty Offices
- 114 Continuing Education and Customized Training
- 114 Law Enforcement Program Office

Student Services Area

- 125 Financial Aid Office
- 126 Information Window
- 128 Admissions Office
- 130 Records and Registration Office
- 133-136, 141 Advisors/Counselors

Administration Area

- 138-139 Business Office
- 145 Chief Fiscal Officer
- 146 Institutional Research Office
- 147 Vice President, Student Affairs
- 148 Human Resources Office
- 149 Student Support Services
- 150 Public Information Office

West Wing

- W105 Administrative Reception Area
- W107 Office of the President
- W108 Vice President, Academic Affairs
- W109 Administrative Conference Room
- W110 Affirmative Action Office
- W111 Institutional Advancement Office
- W115-W117 Staff Offices
- W118 Career Resource Center
- W119 Assistive Technology Lab
- W120 Testing Center
- W121 Center for Academic Achievement
- W122 Main Conference Room

South Hall

- 156 Art Gallery
- 166 Interactive Television Classroom
- 167 Art Classroom
- 176 Child Care Center
- 186 Environmental Science Lab
- 187 Art Studio
- 188 Classroom
- 192 College Bookstore
- 194 Music Lab
- 195 Auditorium

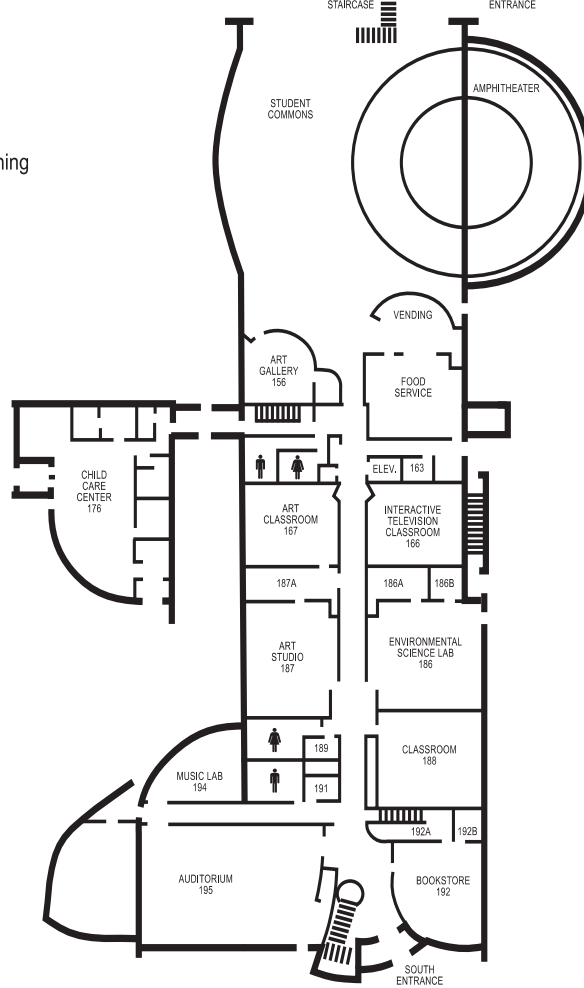

SECOND FLOOR

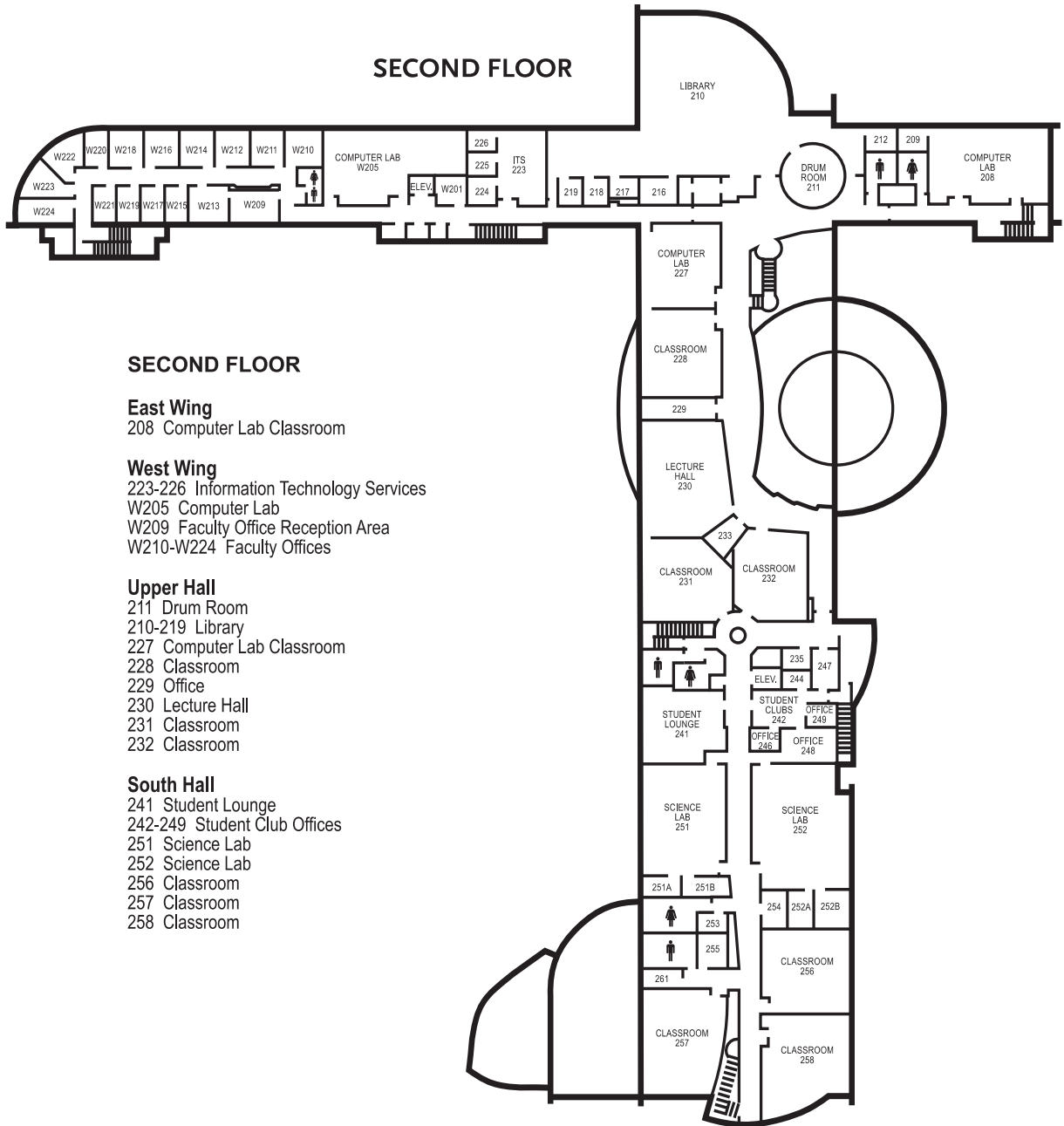

SECOND FLOOR

East Wing

208 Computer Lab Classroom

West Wing

223-226 Information Technology Services

W205 Computer Lab

W209 Faculty Office Reception Area

W210-W224 Faculty Offices

Upper Hall

211 Drum Room

210-219 Library

227 Computer Lab Classroom

228 Classroom

229 Office

230 Lecture Hall

231 Classroom

232 Classroom

South Hall

241 Student Lounge

242-249 Student Club Offices

251 Science Lab

252 Science Lab

256 Classroom

257 Classroom

258 Classroom

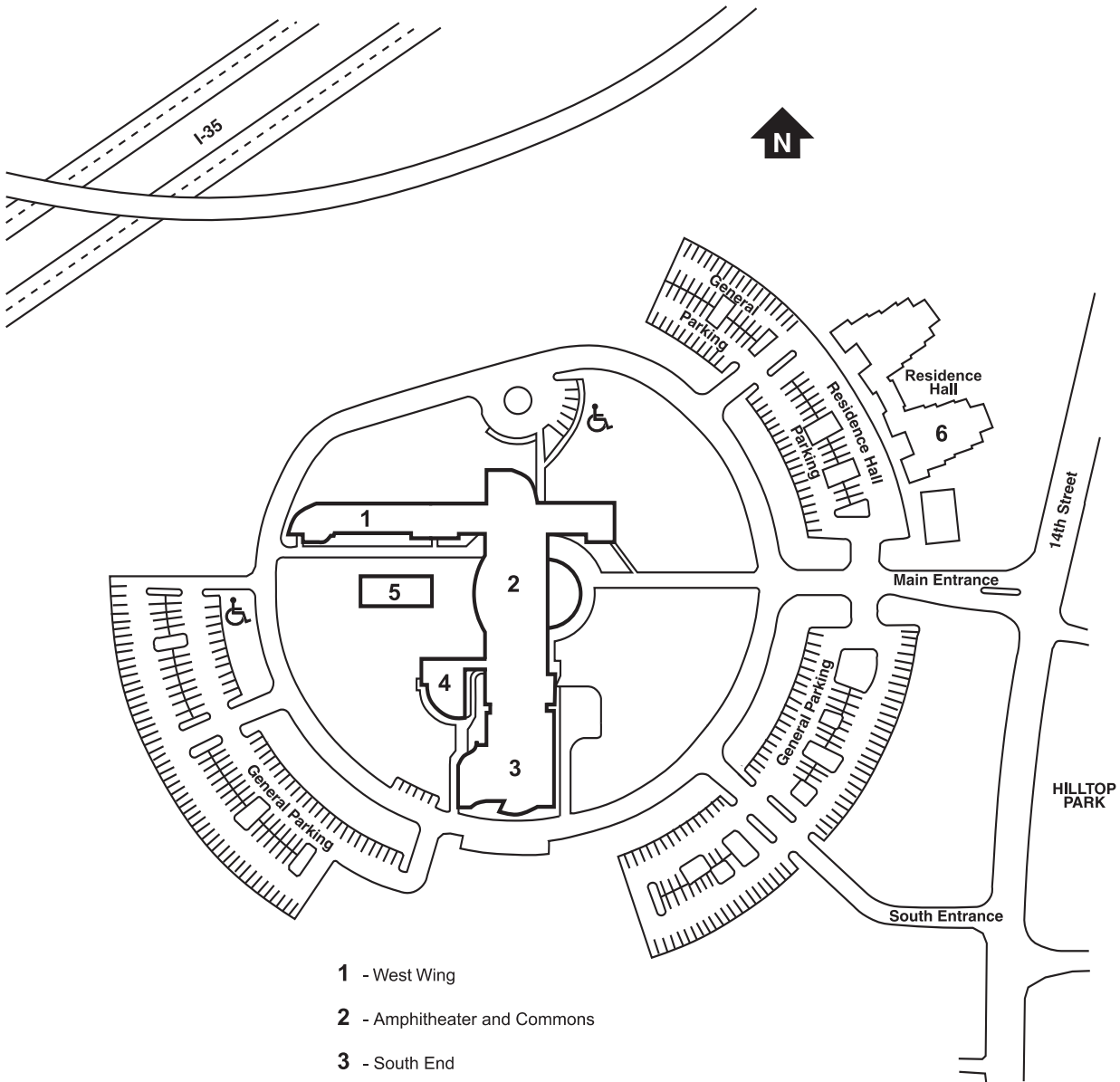

- 1 - West Wing
- 2 - Amphitheater and Commons
- 3 - South End
- 4 - Childcare Center
- 5 - Center of Excellence
- 6 - Residence Hall



Directions to:
 Fond du Lac Tribal & Community College
 2101 14th Street • Cloquet, MN 55720
 (218) 879-0800 • TTY (218) 879-0805
 1-800-657-3712 • Fax (218) 879-0814

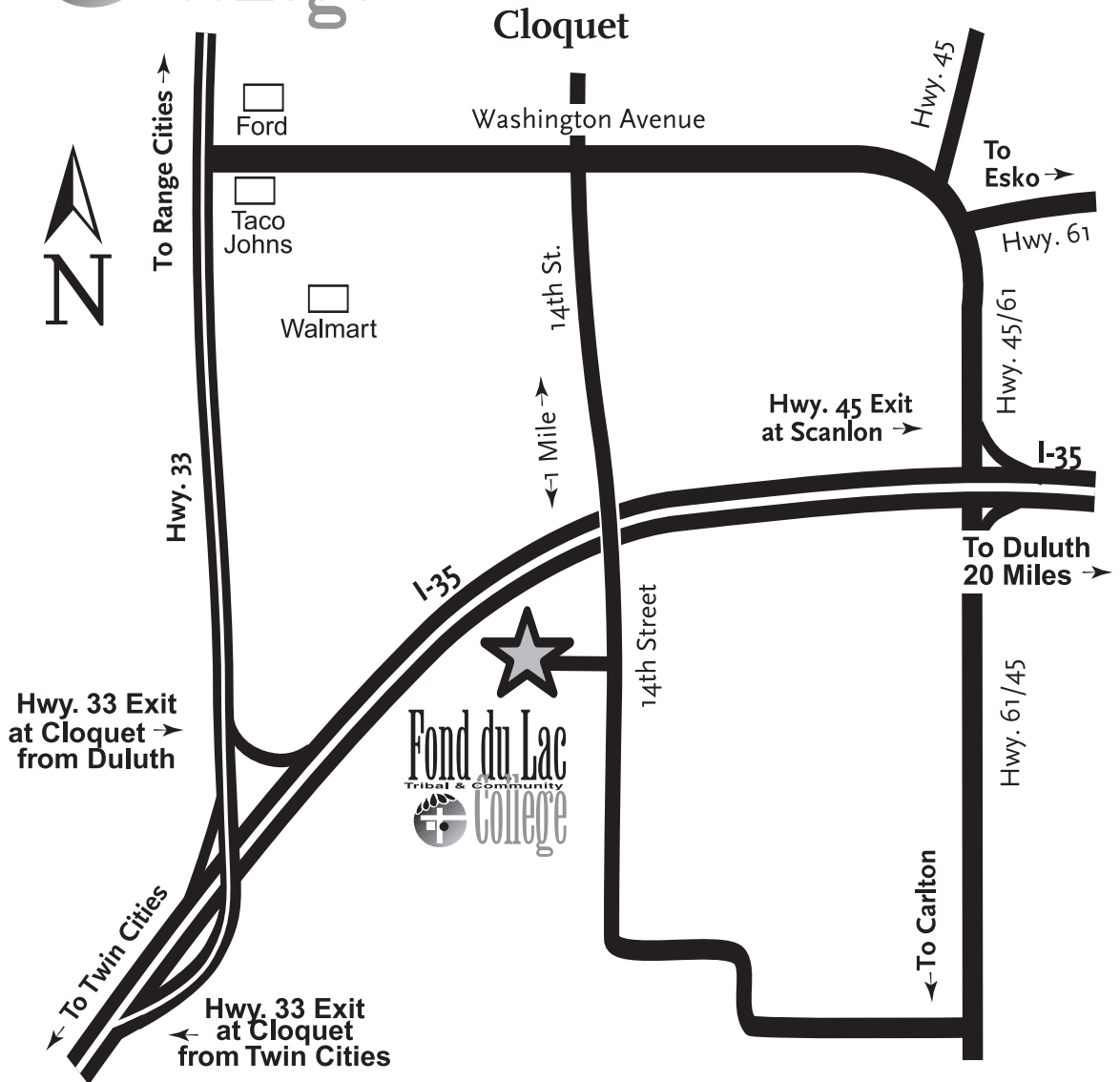

Fond du Lac Tribal & Community College is located in Cloquet, approximately 130 miles north of Minneapolis/St. Paul, and 20 miles southwest of Duluth. From Interstate 35, exit on Highway 33 north into Cloquet. Follow Highway 33 approximately one mile and turn right onto Washington Avenue. Follow Washington Avenue to 14th Street, which is the first four-way stop sign intersection. Turn right onto 14th Street and follow approximately one mile to the college campus, which is on the right-hand side of the street